

SCHOOL BOARD  
LIAISON CTTEE

SCHOOL BOARD/MUNICIPAL LIAISON COMMITTEE

DISTRICT OF COQUITLAM

MEETING MINUTES

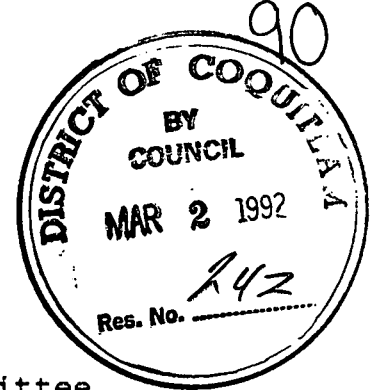

A meeting of the School Board/Municipal Liaison Committee was convened at 8:00 a.m., Monday, February 17, 1992 in the Board Room of the School District Office.

**COUNCIL MEMBERS;**

Ald. M. Reid  
Ald. B. Robinson

**TRUSTEES:**

Trustee K. Becker  
Trustee M. Wilson

**DISTRICT OF COQUITLAM STAFF:**

T. Klassen,  
Director of Admin. Srvs.

D. Buchanan  
Planning Director

D. Cunnings  
Parks & Rec. Director

**SCHOOL BOARD STAFF:**

S.W. Urdahl  
Secretary-Treasurer

T. Harris  
Assistant Supt.

**I. MINUTES OF OCTOBER 15TH MEETING**

The Minutes were approved as distributed.

**II. FUNDING REQUESTS--ADVENTURE PLAYGROUNDS**

For the benefit of new Committee reps from Council an overview was given on the background to the tripartite adventure playground funding agreement. This agreement had been instituted to ensure that funding was coordinated between the school district and municipality with the maximum contribution of each party of \$3500. Total budget amount of \$15,000 for each budget year for the school district and municipality. In this way parent groups would not lobby and whipsaw between councils and the school district for funding requests. The parent group's contribution in many cases far exceeds their required contribution of \$3500.

Funding requests had been received from three elementary schools -- Mundy Road, Miller Park, and Panorama Heights.

ROBINSON/WILSON moved that a recommendation be made to Council and Board of School Trustees for contributions towards the development of adventure playgrounds at Mundy Road and Miller Park elementary schools and that funding for Panorama Heights be deferred until staff has reviewed the site for an appropriate location.

*APP'D  
MAY 24/5*

CARRIED

**III. GLEN PARK/SCHOOL PARKING LOT**

The Glen School parking lot is now operational and is functioning well. Concern was expressed that the parking lot may be used for permanent parking by residents living in the townhouses adjoining school property.

REID/ROBINSON moved that appropriate signage be installed immediately at the parking lot prohibiting overnight parking and providing adequate restrictions so that the parking lot is only available for school and park users.

COUNCIL  
ACTION  
REQUIRED

*MAY 24/3  
APP'D*

CARRIED

The Glen parent group requested that the development of Glen Park occur in conjunction with the school district. The Committee felt that this request is somewhat premature as a master plan has to be refined. It was agreed that a round table discussion with the public was required, but without creating an expectation. Public involvement in some aspects of the work in the park may be desirable. It was agreed that a round table discussion on the development of Glen Park take place with the public and Liaison Committee this spring and it be so recommended to both Council and Board of School Trustees.

COUNCIL  
ACTION  
REQUIRED

*SEE  
MAY 24/4*

**IV. CENTENNIAL SCHOOL PARKING UPDATE**

- Centennial students have been assigned the use of the east end of the ice arena parking lot and it appears to be working reasonably well.

**V. POTENTIAL JOINT DEVELOPMENTS**

5.1 Plateau Elementary sites

Panorama Heights elementary has been completed and the school district is proceeding with the development of the east plateau elementary site, hoping that construction will take place this fall with occupancy being 1993/94.

Concern was expressed that under the option agreement the highest and best use will determine the value when the Board acquires the property. In many areas re-zoning is being sought by the developer from residential to multi-family. This could cause an escalation in price to the school district in acquiring the next portion of land if the zoning requirements have been up-graded.

#### 5.2 North East Coquitlam Elementary Sites

The school district is in the process of acquiring.

#### 5.3 Plateau Middle

A request for funding has been submitted to the Ministry for the 1992/93 capital budget. We are hoping to acquire this site so that architects can be assigned for the development of a middle school.

#### 5.4 Eagle Ridge Middle

The school district is hoping for funding to design and construct a school in the 1992/93 capital budget.

#### 5.5 Plateau/Town Centre Secondary

Two separate secondary schools for grades 9 to 12 are needed. One property is already owned by the district located at Guildford and Lansdowne. For the second property the Board hopes to acquire some land in the Town Centre area for the potential joint development and use by the school district, Recreation Department, and Douglas College.

### VI. ELEMENTARY SCHOOL TRACK MEETS

#### 6.1 Dates

May 25, 26, 27, and 28.

#### 6.2 Location

Town Centre Stadium.

### VII. DISPOSAL OF LAND

The school district provided the Committee with a package of potential surplus lands for review by the Planning and Engineering Departments as to whether or not the lands could be sold and what the highest and best zoning would be in each instance. Any sales of land by the school district would provide much needed funding that could be applied to local projects.

**VIII. WORK IN PROGRESS**

Reports will be presented at the next meeting.

**IX. OTHER BUSINESS**

Invitations to municipal council/staff regarding new school openings?

**X. NEXT MEETING DATE**

To be arranged by staff representatives.

SWU:jr

COQLIAMI.DOC

SCHOOL BOARD/MUNICIPAL LIAISON COMMITTEE MEETING MINUTES

A meeting of the School Board/Municipal Liaison Committee was convened at 8:00 a.m. on Monday, October 5, 1992, in the Board Room of the School District offices, with the following persons present:

- MUNICIPAL COUNCIL MEMBERS: Councillor B. Robinson (Chairman of today's Meeting)
- SCHOOL BOARD TRUSTEES: Trustee K. Becker  
Trustee M. Wilson
- DISTRICT OF COQUITLAM STAFF: N. Cook, Municipal Manager  
D. Cunnings, Parks & Recreation Director
- SCHOOL BOARD STAFF: T. Harris, Superintendent of Schools  
S. W. Urdahl, Secretary-Treasurer

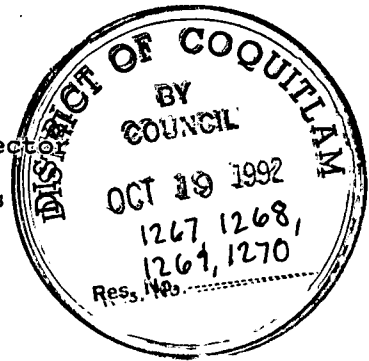

ITEM I - MINUTES OF FEBRUARY 17, 1992

Moved by Trustee Becker  
Seconded by Trustee Wilson

**ACTION:** "That the Minutes of the School Board/Municipal Liaison Committee held February 17, 1992 be approved."

Carried Unanimously

ITEM II - BUSINESS ARISING FROM MINUTES

1. Panorama Heights Home and School Association Capital Playground Equipment Financial Assistance Request

The meeting reviewed the undated letter from the Panorama Heights Home and School Association received by the District of Coquitlam's Park and Recreation Office on September 18, 1992, together with its attachment, and the Park and Recreation Director drew the Committee's attention to the attached photograph (II-I) that portrays the School District staff installing the base for one of the basketball backboards within the area where the adventure playground for the older students would be positioned.

Moved by Trustee Wilson  
Seconded by Trustee Becker

**COUNCIL/BOARD  
ACTION  
REQUIRED:**

That the Board of School Trustees and the Council of the District of Coquitlam each authorize a contribution in the amount of \$3,500 to facilitate the development of a joint school/park adventure playground on the Panorama Heights elementary school in concert with the sketch plan provided by the Panorama Heights Home and School Association and date stamp received by the Parks and Recreation Department on September 18, 1992.

2. Glen School/Park Public Meeting

The meeting was advised that the District of Coquitlam Council did not wish to hold a public meeting--at this time--on the future of the Glen School/Park site due to the difficulty in managing public expectations after such meetings; and, particularly, when a funding vehicle was not in place. After all is said and done, in such circumstances, more would be said than done.

**ITEM III - NEW BUSINESS**

1. Update on Westwood Plateau School Site Public Meeting held on September 29, 1992

Trustees Becker and Wilson informed the meeting that the residents who attended the Westwood Plateau School Site Public Meeting were extremely pleased with the results of joint Panorama School/Park project, and the citizens encouraged the Board to continue to strengthen such partnerlike ties with the Municipality. The Trustees also expressed their undisguised delight with Mr. Eric Tiessen's contribution to the meeting pertaining to the polemical question of school site purchases within the Westwood Plateau development.

2. Miller Park Parent Group Tot Lot Opening - A Tripartite Funding Project

Councillor B. Robinson reported that on Wednesday, September 30, 1992, that he, in the presence of Mayor Sekora and Trustee Wilson, had turned over a District of Coquitlam cheque in the amount of \$3,500 to Mrs. Susan Morrison of the Miller Park Parent Group. Councillor Robinson further advised the meeting that this was a one-time outright grant to the Miller Park Parent Group to assist in funding a joint community/school play space for tiny tots of the school and the adjoining neighbourhood.

3. West Plateau Joint School/Park Site - Utilizing a Portion of the B.C. Hydro 500 kv Right of Way

The Park and Recreation Director drew to the Committee's attention the coniferous forest stand on the eastern edge of the 500 kv Hydro Right of Way immediately south of the joint West School/Park site within the Westwood Plateau lands. The meeting learned that this coniferous stand would have to be destroyed if a combined baseball/soccer playing field complex was to be constructed beneath the 500 kv lines.

It was the staff's recommendation that a joint Municipal/School District Staff Committee be struck to investigate the possibility of transferring the playing field improvements scheduled to be constructed on the B.C. Hydro Right-of-Way, south of the West School site, to the Westwood Plateau Middle School land just east of the Scott Creek ravine.

Moved by Trustee Becker  
Seconded by Trustee Wilson

**COUNCIL/BOARD  
ACTION**

**REQUIRED:**

That Council and the School Board authorize the establishment of a joint staff group to investigate and report back to the Liaison Committee on the feasibility of transferring the planned athletic facilities on the B.C. Hydro Right-of-Way, south of the West School/Park site, to the Westwood Plateau Middle School property.

4. Surplus S.D. Property

Committee Action: That this item be placed on the next agenda of the Municipal/School Board Liaison Committee Meeting.

5. New Town Centre Aquatic Complex

The District of Coquitlam group gave--in brief compass--an overview on the combined 50 m swimming pool and wave pool complex, together with its ancillary facilities. (See attached plan.)

**ITEM IV - OTHER BUSINESS**

1. Parkland Elementary School Adventure Playground Redevelopment

The Superintendent of School presented the meeting with a memorandum from Mrs. Joan Beck, Ass't Superintendent of Schools, recommending that the Liaison Committee give favourable consideration to financially assisting the redevelopment of the ageing Parkland joint community/school playground equipment and, further advised, that the parent group had raised \$20,000 towards this \$27,000 Adventure Playground Redevelopment project.

The Parks and Recreation Director also drew to the Committee's attention that, to date, the following neighbourhood/school projects had been recommended to receive subventions from the two respective \$15,000 budgets.

|  | <u>District</u> | <u>School Board</u> |
|--|-----------------|---------------------|
| (a) Mundy Road Joint Neighbourhood/School  | \$ 3,500        | \$ 3,500            |
| (b) Miller Park Joint Neighbourhood/School | 3,500           | 3,500               |
| (c) Panorama Joint Neighbourhood/School    | 3,500           | 3,500               |
| (d) Parkland Joint Neighbourhood/School    | 3,500           | 3,500               |
|  | <u>\$14,000</u> | <u>\$14,000</u>     |

Moved by Trustee Becker  
Seconded by Trustee Wilson

**COUNCIL/BOARD  
ACTION**

**REQUIRED:** That the School Board and the District of Coquitlam Council each authorize the sum of \$3,500 to facilitate the redevelopment of the Parkland Elementary joint school/park adventure playground.

2. Nomination of Names for Schools

Committee Action: The Secretary/Treasurer, S. Urdahl, was requested by the Committee to provide the Municipal Manager's office with a list of school site locations that require name nominations.

**ITEM V - TABLED ITEMS**

- T-1 Panorama Elementary School Portables
- T-2 Province Newspaper Article re. Health Risks of Living near High-Voltage Power Lines

**ITEM VI - DATE OF NEXT MEETING**

The meeting tacitly agreed that the next meeting of the Liaison Committee will be held on Monday, November 2, 1992 at 0800 hours in the School District's boardroom with Trustee K. Becker chairing the meeting and S. Urdahl preparing the agenda.

**ITEM VII - ADJOURNMENT**

The meeting adjourned at 9:00 a.m.

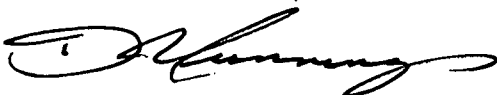

D.L. Cunnings  
Parks & Recreation Director



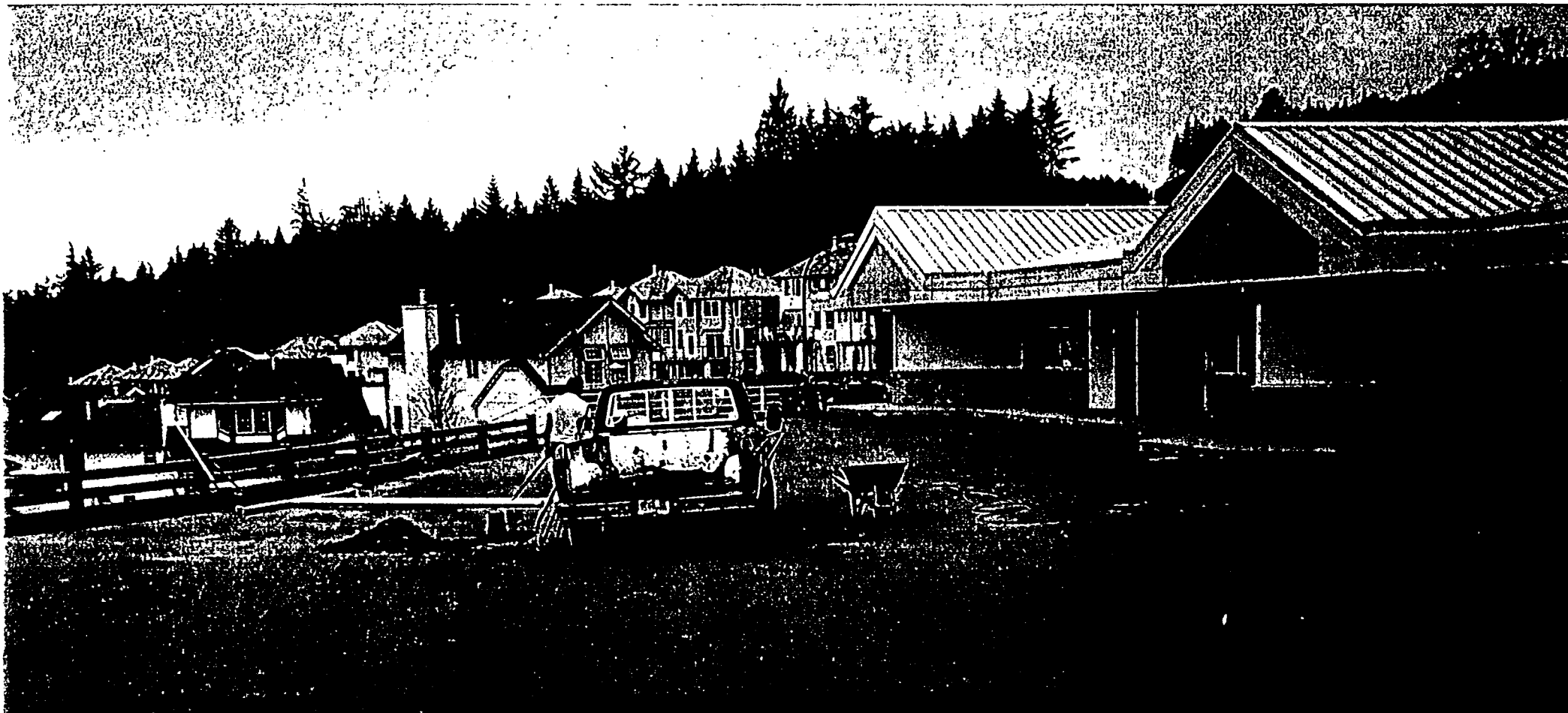

PANORAMA JOINT SCHOOL/PARK

PLAY SPACE  
(For Older Students)

ITEM II-1

Panorama Heights Home and School Association  
1455 Johnson Street  
Coquitlam, B.C.  
V3E 2T1

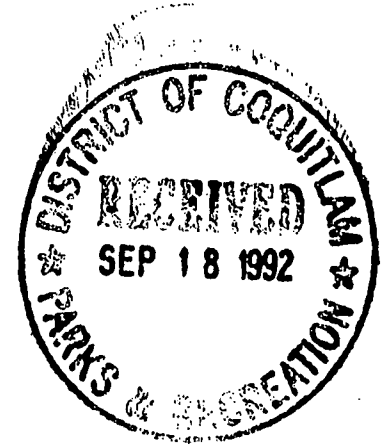

Parks and Recreation/School Board Liason Committee  
c/o Mr. Don Cunnings  
633 Poirier Street  
Coquitlam, B.C.  
V3J 6A9

Dear Mr. Cunnings,

Please find enclosed the sketch you requested outlining the site for Panoram Heights Elementary School adventure playground. Funding for the site preparation has been provided and the site is now complete as per District School Board and CSA safety standards.

The Home and School Association is hopeful that your assistance with funding will enable us to purchase and install adventure playground equipment in this site by the end of this calendar year.

Yours sincerely

A handwritten signature in cursive script that reads "D. Bergman".

Dawna Bergman  
Co-ordinator PHEHSA

Building

Sidewalk

Sidewalk

Sidewalk.

TETHERBALL

Tetherball

BASKETBALL

PLANTER  
& BENCHES

6x6 Edge around perimeter

BICYCLE RACK

EXISTING RAIL FENCE

New Stairs

\*This drawing is NOT TO SCALE

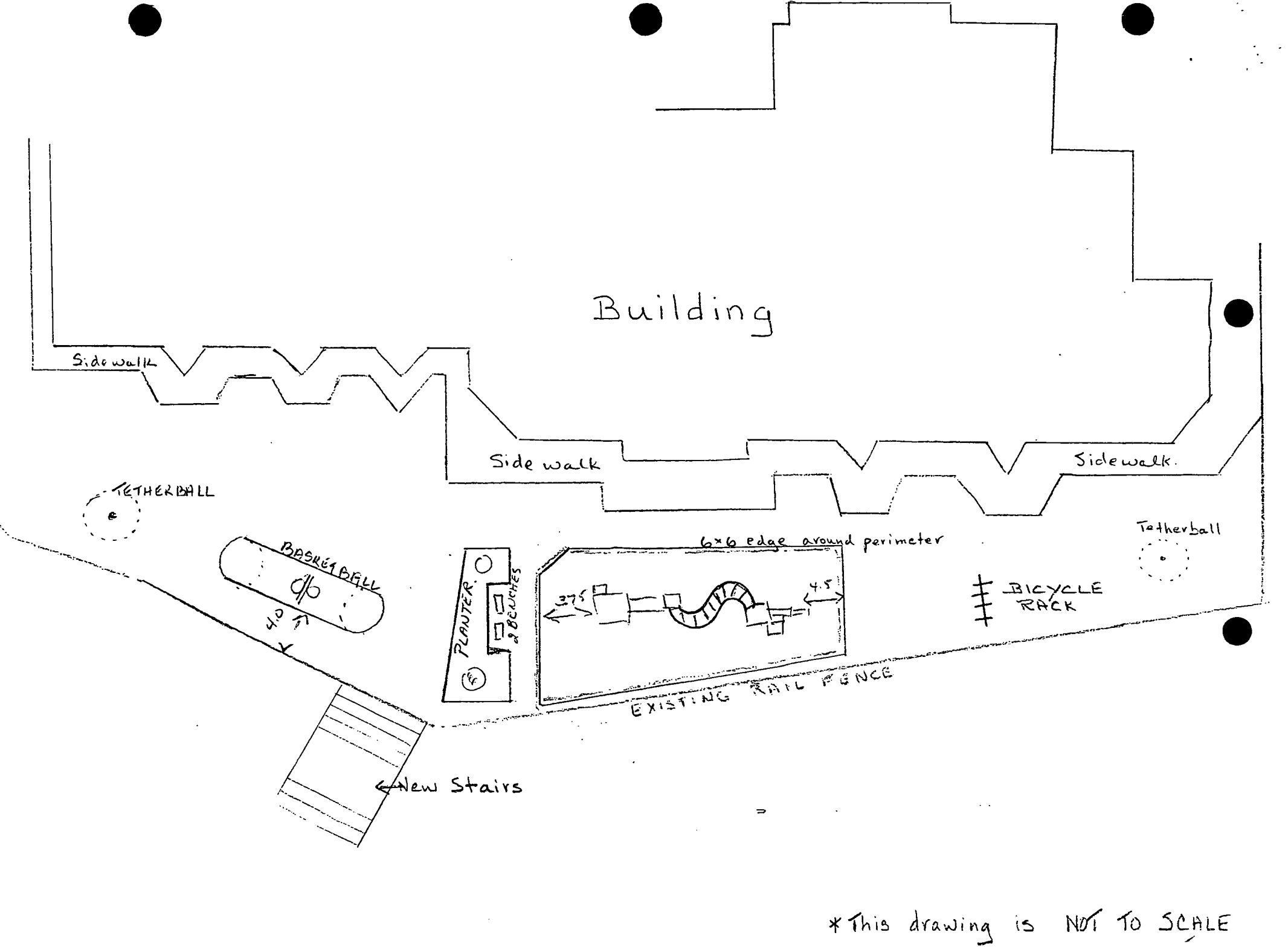

# PANORAMA JOINT SCHOOL / PARK

PLAY SPACE (For Tiny Tots)





MILLER PARK ELEMENTARY JOINT MUNICIPAL/SCHOOL BOARD PLAY SPACE

(For Tiny Tots) OPENING - September 30, 1992

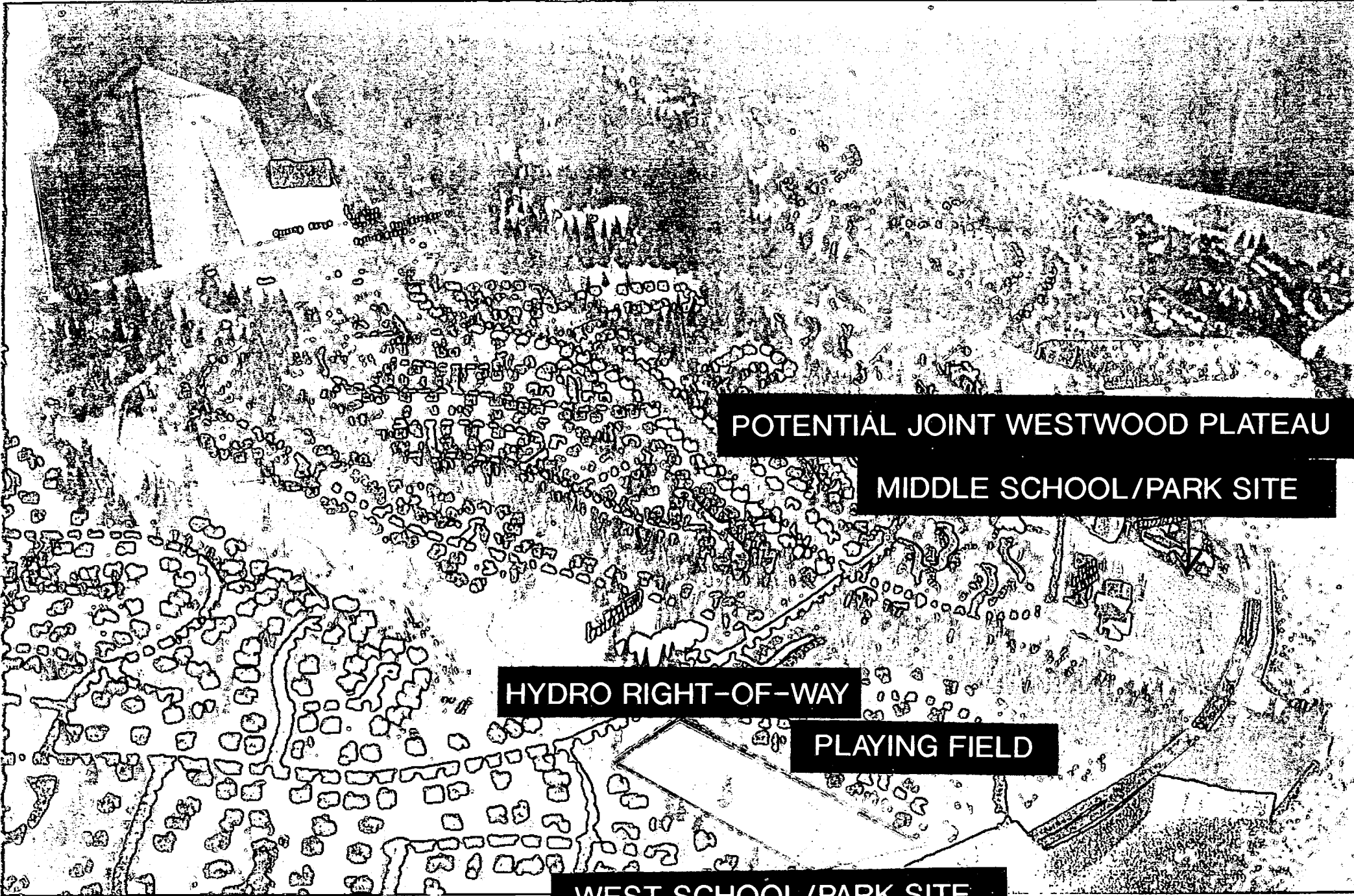

POTENTIAL JOINT WESTWOOD PLATEAU

MIDDLE SCHOOL/PARK SITE

HYDRO RIGHT-OF-WAY

PLAYING FIELD

WEST SCHOOL/PARK SITE

HYDRO RIGHT-OF-WAY CONIFEROUS TREE STAND

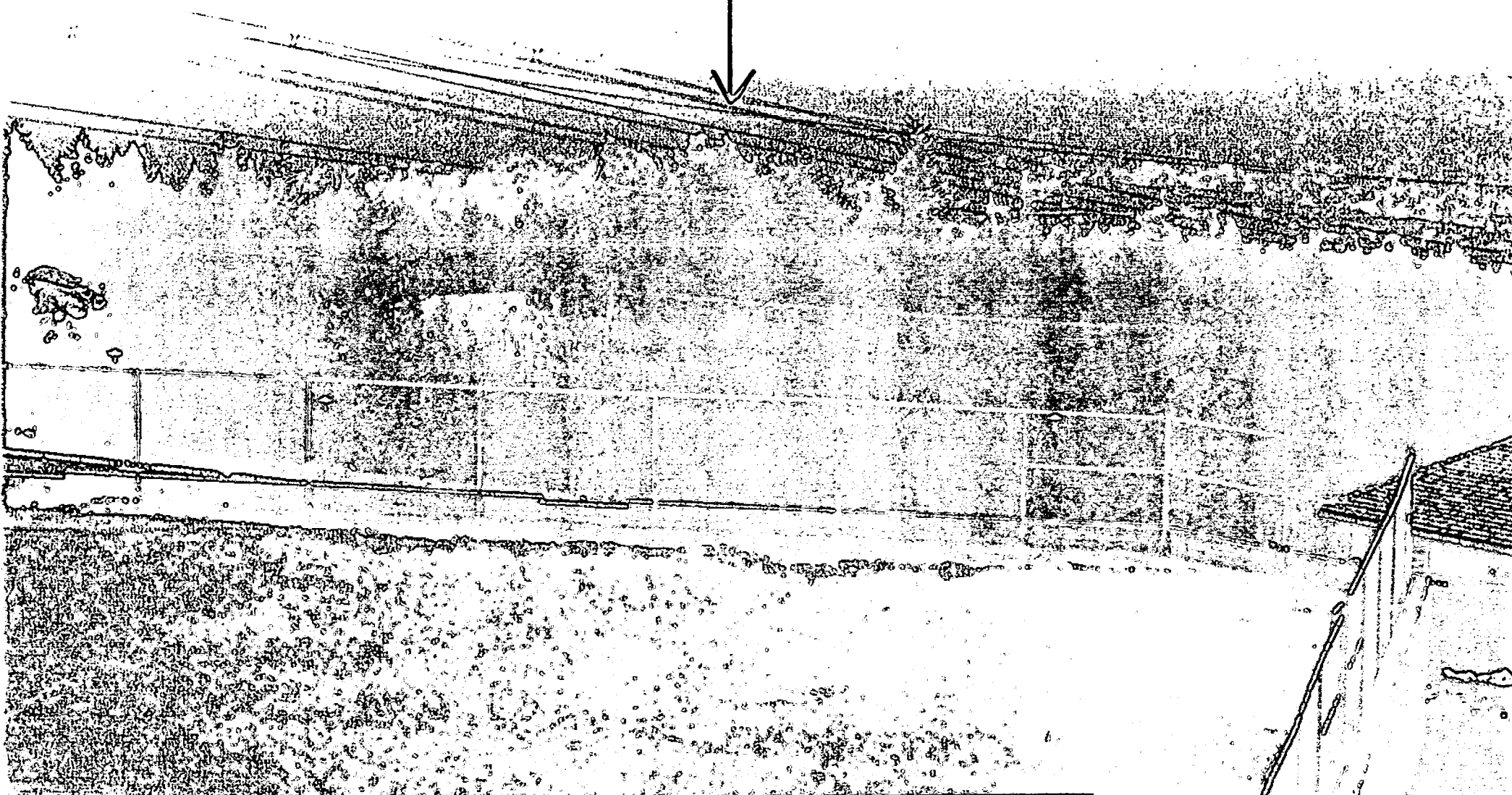

WESTWOOD PLATEAU 'WEST' RESERVOIR TENNIS COURTS



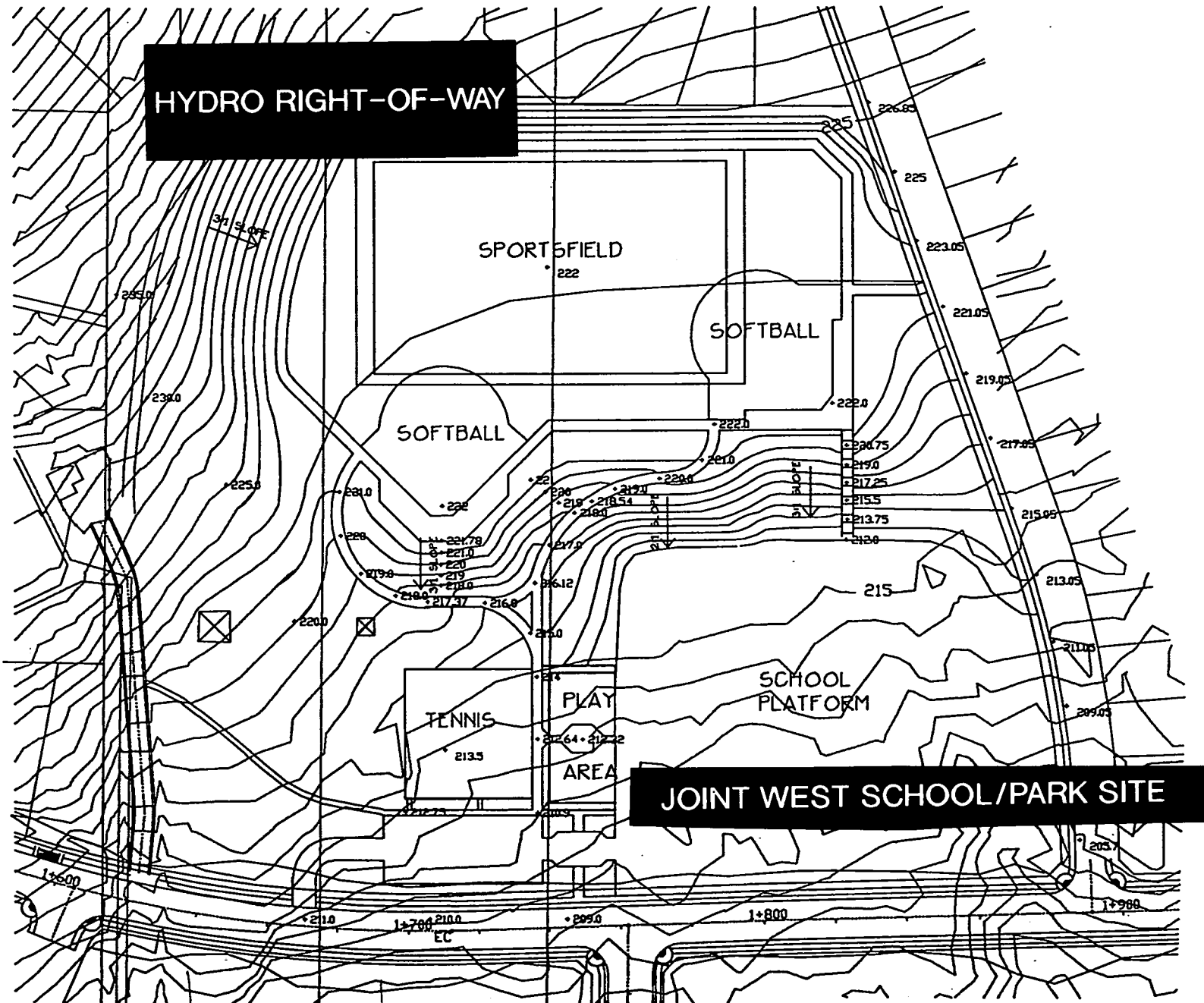

**HYDRO RIGHT-OF-WAY**

**JOINT WEST SCHOOL/PARK SITE**

A Copyright reserved. This drawing and schedule by the property of the site group (landscape architects & Park Planning), and may not be reproduced or used for other projects without written permission of the firm.

| NO. | DATE | REVISION | DESCRIPTION |
|-----|------|----------|-------------|
|     |      |          |             |
|     |      |          |             |
|     |      |          |             |
|     |      |          |             |
|     |      |          |             |
|     |      |          |             |
|     |      |          |             |
|     |      |          |             |
|     |      |          |             |
|     |      |          |             |
|     |      |          |             |

**the dm group**  
 Landscape Architects & Park Planners  
 A Partnership of  
 DAN McBRIDE ARCHITECTS LTD.  
 210 UNIVERSITY & MARSHALL CTS.  
 TORONTO, ONTARIO M5S 1A8  
 (416) 924-4101 FAX: (416) 924-4102

**PROJECT:**  
 WEST PARK  
**WESTWOOD HEIGHTS**  
**WESBOLD ENTERPRISES LTD.**

**DRAWING TITLE:**  
**SITEPLAN**

|                         |             |
|-------------------------|-------------|
| SCALE: as shown         | <b>L- 1</b> |
| DRAWN: [blank]          |             |
| CHECKED: [blank]        |             |
| DATE: [blank]           |             |
| PROJECT NUMBER: 89-178A |             |

*confd*



ITEM III-3C

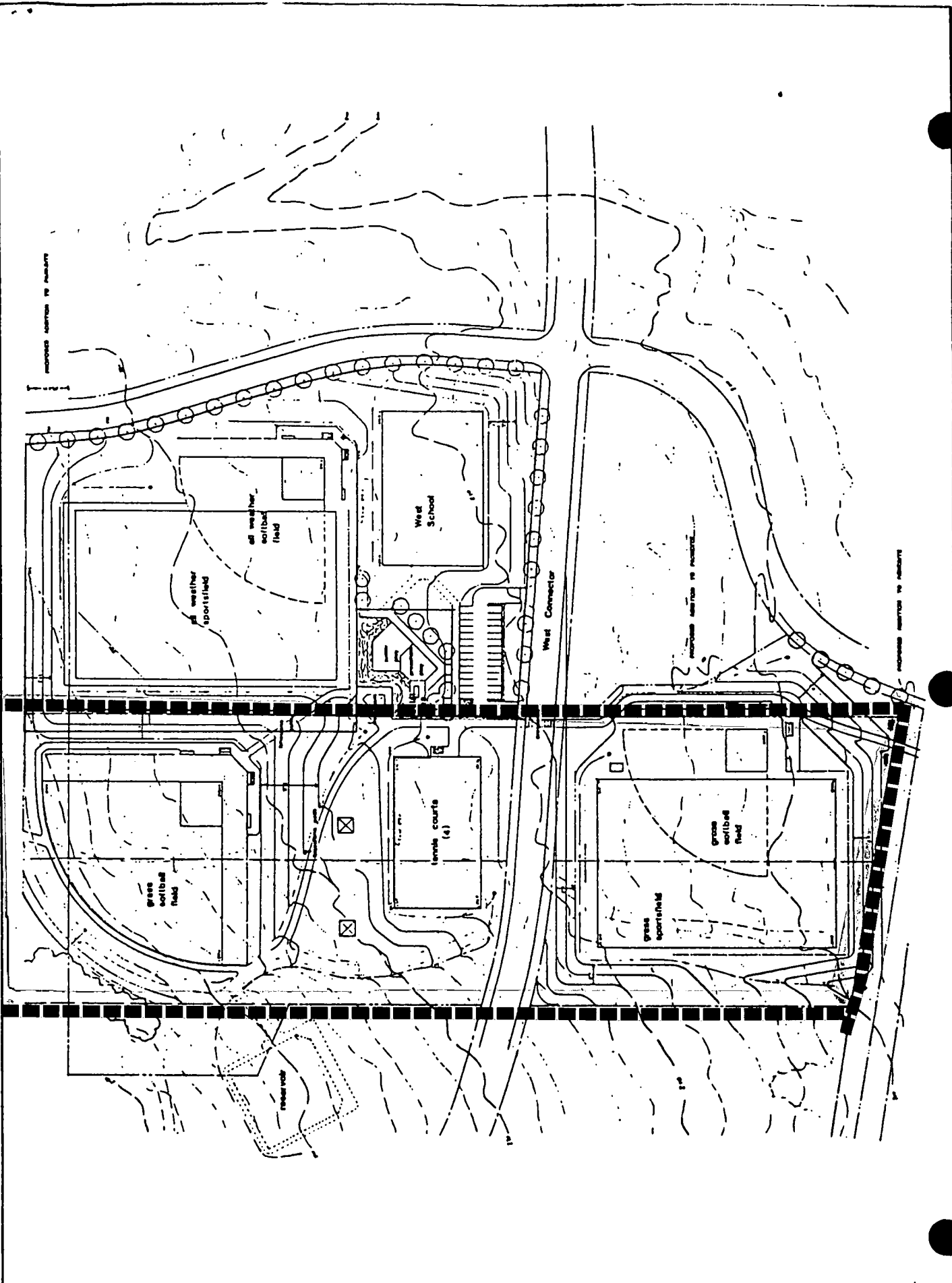

|  |   |  |  |  |
|--|---|--|--|--|
|  | <p>district of<br/><b>COQUITLAM</b></p> | <p>project title<br/><b>WESTWOOD HEIGHTS<br/>DEVELOPMENT AGREEMENT</b></p> <p>sheet title<br/><b>WEST SCHOOL / PARK<br/>Concept Plan</b></p> | <p>legend</p> <ul style="list-style-type: none"> <li> EXISTING TREES TO BE RETAINED</li> <li> BANK-HYDRATED WILDFLOWERS</li> <li> GRASS (Slope 3:1 or less)</li> <li> ORNAMENTAL SHRUBS</li> <li> PARK/SCHOOL PROPERTY LINE</li> <li> TOP OF CREEK BANK</li> </ul> | <p>schedule<br/><b>F<sub>2</sub></b></p> |
|--|---|--|--|--|

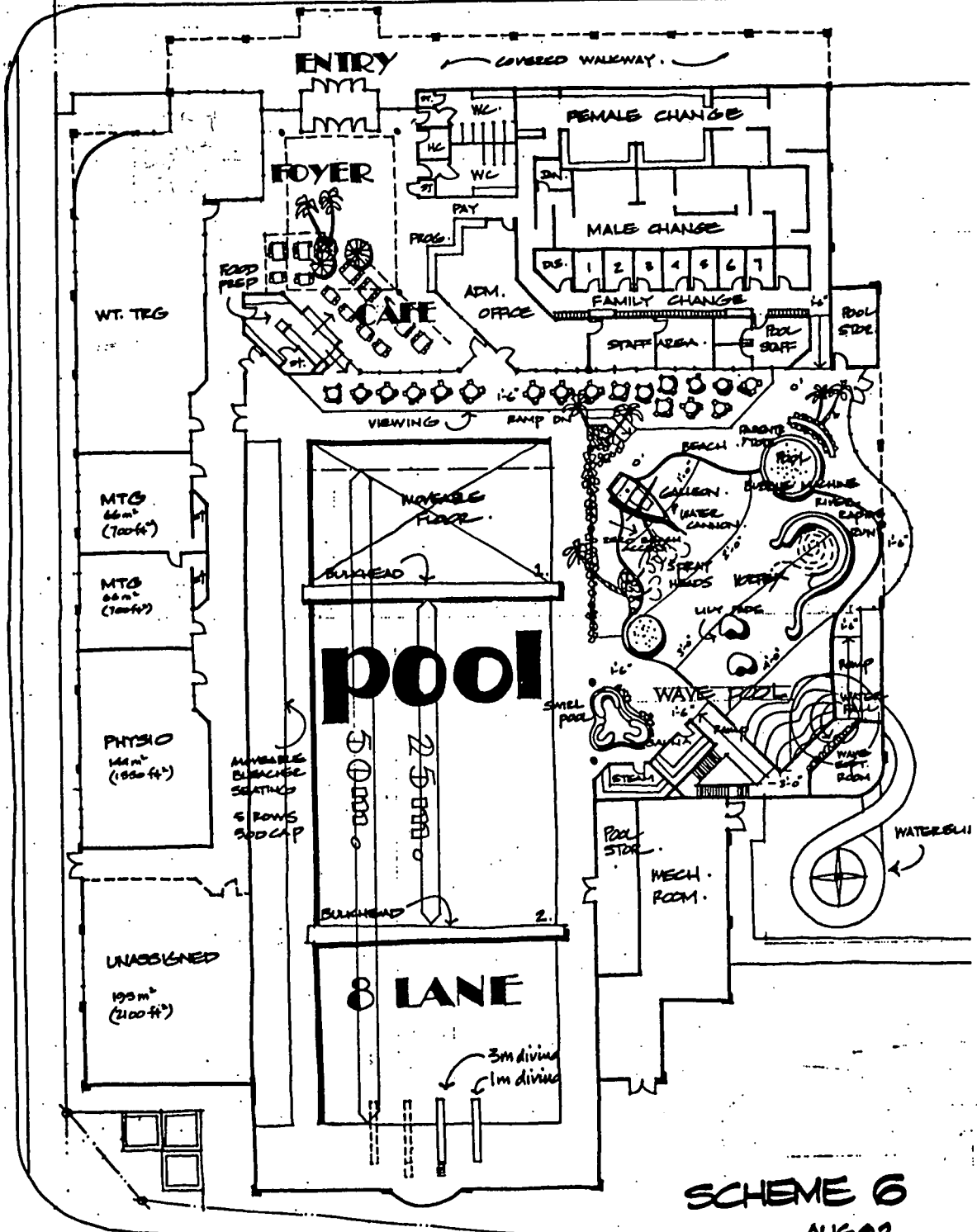

**SCHEME 6**  
AUG 92.

# TOWN CENTRE AQUATIC COMPLEX

VIC DAVIES ARCHITECTS LTD

ITEM IV-1

School District No 43 (Coquitlam)  
MEMORANDUM

TO: Tom Harris  
FROM: Joan Beck  
DATE: 1992-10-02

RE: ADVENTURE PLAYGROUND

The parents of Parkland Elementary School have purchased playground equipment through fund-raising. The preparation of the site and installation of all the equipment is estimated at \$7,000.

This playground will provide many years of learning and enjoyment to all children in this area of Coquitlam. Since there is no other playground nearby we ask that through the liaison committee, the District of Coquitlam share in the preparation and installation costs.

The parents are anxious to proceed with the installation and await the approval of the Board/District Liaison Committee.

Thank you for reviewing this request.



JB:ph

(docpkldadv)

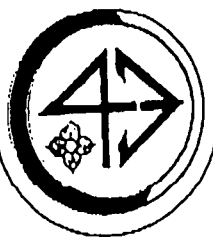

# School District No. 43 (Coquitlam)

550 Poirier Street - Coquitlam, B.C. - V3J 6A7 - Tel. 939-9201 - Fax. 939-6400

P-180(d)

File 108.1

1992-09-29

Mr. D. Cunnings, Director  
Parks and Recreation Department  
District of Coquitlam  
633 Poirier Street  
Coquitlam, B. C.  
V3J 6A9

Dear Mr. Cunnings:

Thank you for your prompt reply to our request regarding the placement of portable classrooms on the joint-use parking lot at Panorama Heights Elementary School. The conditions stated in your affirmative response are acceptable.

It is requested that the Engineering Department liaise directly with the school principal, Ken Gordon, regarding the permit parking passes for staff.

Thank you for your cooperation in assisting us with meeting the accommodation needs of students in the Panorama Heights Elementary School area.

Yours truly,

SCHOOL DISTRICT NO. 43 (COQUITLAM)

  
W. J. Low, P. Eng.  
Manager of Facilities

WJL/bm

- c.c. N. Nyberg, Municipal Engineer
- T. Harris
- S. Urdahl
- R. Carson
- K. Gordon, Principal, Panorama Heights Elementary School

# DISTRICT OF COQUITLAM

Parks & Recreation  
633 Poirier Street  
Coquitlam, B.C. V3J 6A9

Phone: (604) 936-3481  
Fax: (604) 936-3975



Mayor: L. Sekora

1992 September 25  
Our file: /08./

Mr. W.J. Low, P. Eng.  
Manager of Facilities  
School District #43 (Coquitlam)  
550 Poirier Street  
Coquitlam, B.C. V3J 6A7

Dear Mr. Low:

**Re.: Portables for Panorama Heights Elementary School**

Further to your written request of 1992 09 16 to place three portable classrooms at the Panorama Heights Elementary School, please accept this letter as your authorization to proceed with the placement of three classroom portables on the "joint-use" parking lot located on the School District property, east of the school gymnasium.

This authorization is made on the condition that during the 1993 Easter school vacation break and during the 1993 summer school vacation break that the primary school parking lot remain open and available to the public wishing to use the Panorama Park facilities. Additionally, as a condition of this approval, the writer requests that teaching staff at the Panorama Elementary School be precluded from parking on the 12 remaining stalls within the east parking lot but, in turn, be issued permit parking passes which would allow them to park in the "Permit Parking Only" zone on Johnson St., contiguous to the school site - an arrangement that is being worked on with our Engineering Department.

Suffice it to say, this office looks forward to the Panorama School gymnasium being freed up to facilitate parks and recreation community-based programs once the aforementioned three classroom portables are on site.

I trust that these conditions will be viewed as acceptable by senior management within the School District, and that the said portables will not be on site as at September 1993.

Yours truly,

A handwritten signature in cursive script, appearing to read "D. Cunnings".

D.L. Cunnings  
Parks & Recreation Director

DLC/js

c - N. Nyberg, Municipal Engineer  
R. Richardson, Deputy-Director, Parks & Recreation  
B. Elliott, Parks Administrator

JOHNSON STREET

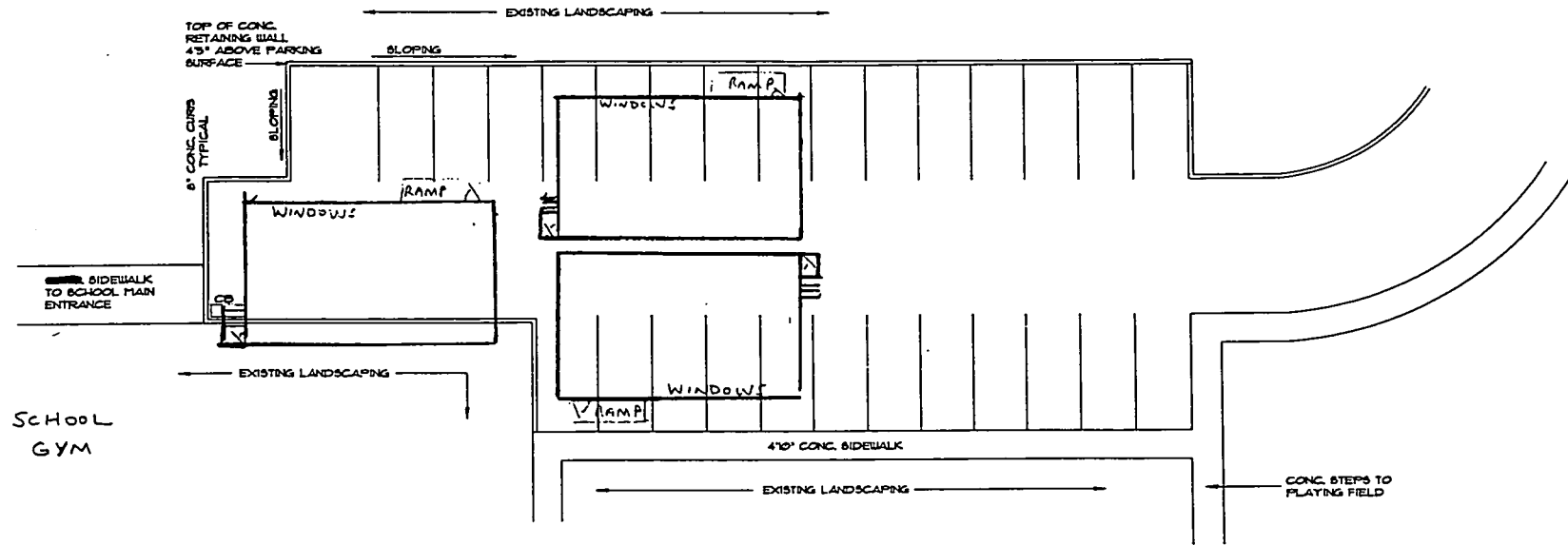

PARKING LOT  
PANORAMA ELEMENTARY  
SCALE 1" = 20'0"



S.D. PROPERTY - SITE FOR TEMPORARY CLASSROOM PORTABLES (3)

# Study of lines risk alarms residents

By John Colebourn  
Staff Reporter

A new study on the health risks of living near high-voltage power lines is worrying some Vancouver families.

"It is quite alarming for us to hear what these power lines can do to your health," said Patti Gilbertson, 36, who has two small children.

## EDITORIAL, Page A28

She and other Boundary Road residents are fighting B.C. Hydro over its refusal to bury the lines outside their homes.

"These towers are far too close to homes," said resident Hollis Barrow.

The study by Sweden's Karolinska Institute found that families, especially children, living within 45 metres (150 feet) of high-voltage overhead lines run double the normal risk of developing leukemia and other cancers.

The study looked at 500,000 Swedes who between 1960 and 1985 lived within 275 metres (900 feet) of overhead lines.

Biophysicist Dr. Andrew Marino at Louisiana State University in Baton Rouge said the Swedish study backs up other research.

"The risk is real," Marino said. "But power companies aren't going to spend the money on underground lines unless they are forced to."

Marino was a witness three years ago in Courtenay, when residents opposed B.C. Hydro's routing of high-voltage power lines near their homes.

B.C. Hydro official Kelly Gibney said the Boundary Road power lines have a small magnetic field, and there is "a big grey area" over how dangerous such lines are.